

# CX-ED2079

## 'UNIVERSAL' GRADE 2 ELECTRIC STRIKE

GRADE

2



CX-ED2079 AND  
STAINLESS STEEL FACEPLATES

### FEATURES

- CENTERLINE LATCH ENTRY, FOR CYLINDRICAL LOCKSETS
- 1/2" - 5/8" (13MM - 16MM) LATCH PROJECTION
- DUAL VOLTAGE 12/24V AC OR DC
- FIELD SELECTABLE FAIL SAFE/FAIL SECURE OPERATION
- HORIZONTAL ADJUSTABILITY OF STRIKE BODY
- LOW PROFILE STRIKE BODY
- 3 STAINLESS STEEL FACEPLATES INCLUDED:
  - ANSI SQUARE 4 7/8" X 1 1/4" (124MM x 32MM)
  - ANSI ROUND 4 7/8" X 1 1/4" (124MM x 32MM)
  - WOOD DOOR 7 15/16" X 1 7/16" (202MM x 37MM)
- 5 YEAR WARRANTY

### DESCRIPTION

**Camden CX-ED2079** low profile grade 2 ANSI strike for cylindrical locksets offers the very best strike quality and performance, with three stainless steel faceplates provided. The 'Universal' strike design delivers unparalleled application flexibility, with field selectable voltage, fail safe/fail secure operation and mechanical adjustment of the strike body.

### APPLICATION

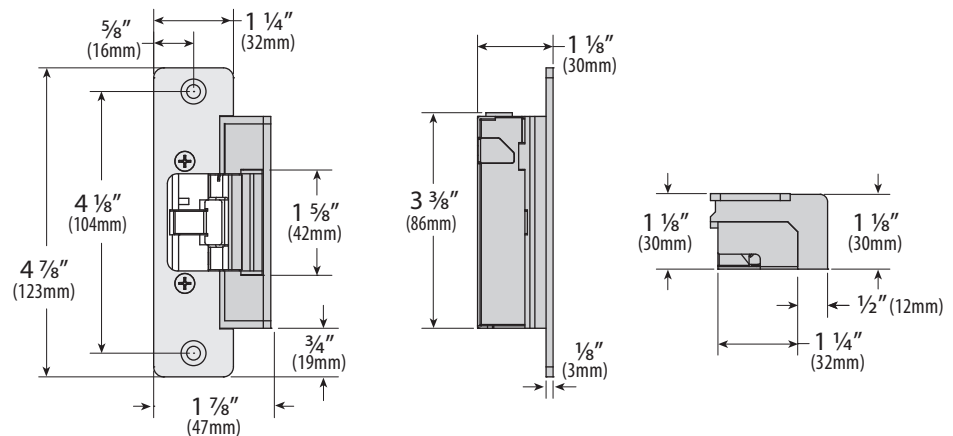

# CX-ED2079L 'UNIVERSAL' GRADE 2 ELECTRIC STRIKE

## DOOR FRAME TYPES



## COMPATIBLE LOCKSETS



## SPECIFICATIONS

VOLTAGE:	12/24V AC/DC
CURRENT DRAW:	300mA@12V DC 150mA@24V DC
STATIC STRENGTH:	1000 LBS.
DYNAMIC STRENGTH:	50 FT-LBS.
ENDURANCE:	700,000 CYCLES
MODE:	FIELD SELECTABLE FAIL SAFE/FAIL SECURE
MECH. ADJUSTMENT:	STRIKE BODY/FACEPLATE
OPERATION:	AC – BUZZ DC – SILENT
DUTY:	CONTINUOUS
DIMENSIONS (BODY):	3 3/8" H x 1 7/8" W x 1 1/8" D (85.7mm x 47mm x 28.6mm )

## FACEPLATES

MODEL	DESCRIPTION
CX-ESP1	ANSI Square, 4 7/8" x 1 1/4", square corners
CX-ESP2	ANSI Round, 4 7/8" x 1 1/4", rounded corners
CX-ESP4	Wood Door, 7 7/8" x 1 3/8", rounded corners

ESP1 - ANSI SQUARE: Overall height 4 7/8" (123mm), overall width 1 1/4" (32mm). Mounting hole offset 5/8" (16mm) from top edge. Mounting hole diameter 3/4" (19mm). Strike body height 3 3/8" (85mm), strike body width 4 1/8" (104mm).

ESP2 - ANSI ROUND: Overall height 4 7/8" (123mm), overall width 1 1/4" (32mm). Mounting hole offset 5/8" (16mm) from top edge. Mounting hole diameter 3/4" (19mm). Strike body height 3 3/8" (85mm), strike body width 4 1/8" (104mm).

ESP4 - WOOD DOOR: Overall height 7 7/8" (200mm), overall width 1 3/8" (36mm). Mounting hole offset 5/8" (16mm) from top edge. Mounting hole diameter 3/4" (19mm). Strike body height 3 3/8" (85mm), strike body width 7 1/2" (189mm). Bottom hole offset 2 1/4" (57mm) from bottom edge.

## ORDERING INFORMATION

CX-ED2079: GRADE 2 ANSI STRIKE FOR CYLINDRICAL LOCKSETS, 12/24 AC/DC, FAIL SAFE/FAIL SECURE, CW 3 FACE PLATES